

## GMP20-TEC2047

20mm Planetary gearbox plus 20 brushless motor

Module	0.35			
Rated torque (kg.cm)	3kg.cm max			
Max momentary tolerance torque (kg.cm)	5kg.cm max			
Reduction ratio	1/4.385 1/5.4	1/19 1/23.6 1/29	1/84 1/104 1/128 1/157	1/370 1/455 1/560 1/690 1/850
Number of gear stages	1	2	3	4
L (mm)	14.3	18.5	22.7	26.9

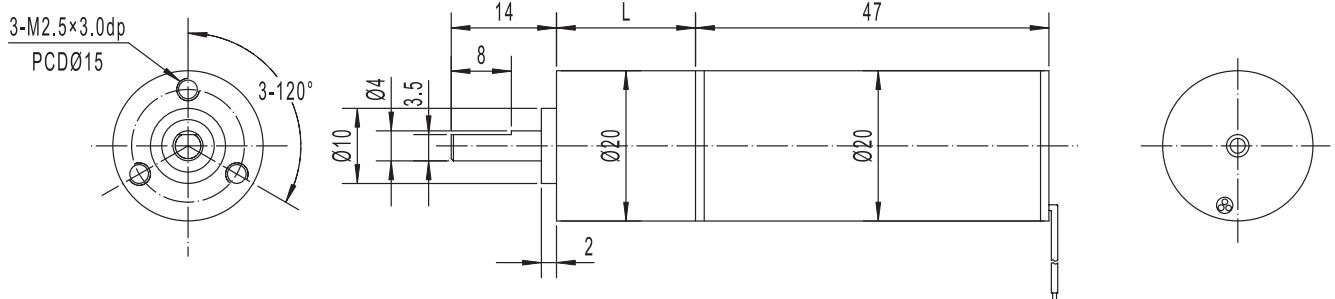

Weight:53g (Approx)

Unit(mm)

### Gear Motor Technical Data

Reduction ratio		5.4	19	29	84	104	128	157	370	560	850
12V	No-load speed(rpm)	925	260	170	59	48	39	31	13	8	6
	Rated speed(rpm)	680	190	125	44	35	29	23	10	7	5
	Rated torque(kg.cm)	0.08	0.25	0.37	0.8	1	1.2	1.6	3	3	3
24V	No-load speed(rpm)	1480	420	275	95	76	62	50	21	14	9
	Rated speed(rpm)	1290	365	240	83	67	54	44	18	13	8
	Rated torque(kg.cm)	0.08	0.25	0.37	0.8	1	1.2	1.6	3	3	3

### Motor Technical Data

Motor model	Rated voltage	No-load		Rated			Stall		
		Speed	Current	Speed	Torque	Current	Power	Torque	Current
	VDC	r/min	mA	r/min	g.cm	mA	W	g.cm	mA
TEC2047-1250	12V	5000	48	3700	20	125	0.75	75	340
TEC2047-2480	24V	8000	35	7000	20	95	1.4	160	505

